

CDXTM

BLOCKS

Create | Play | Imagine

FUN FAIR

Box Quantity: 12
You can mix-and-match Fun Fair models to fill a box!

The CDX Fun Fair Series is a line of building block construction kits based around fairground and carnival style amusement rides.

All of the models are engineered to function like their full sized counterparts, with rotating seats, cars, and platforms.

The rides are very mechanical in operation, with numerous shafts, gears, and gear racks intermingling to create a beautiful symphony of movement. As a result, the Fun Fair models possess a high degree of playability and interaction. Best of all, they are reasonably priced and provide excellent value.

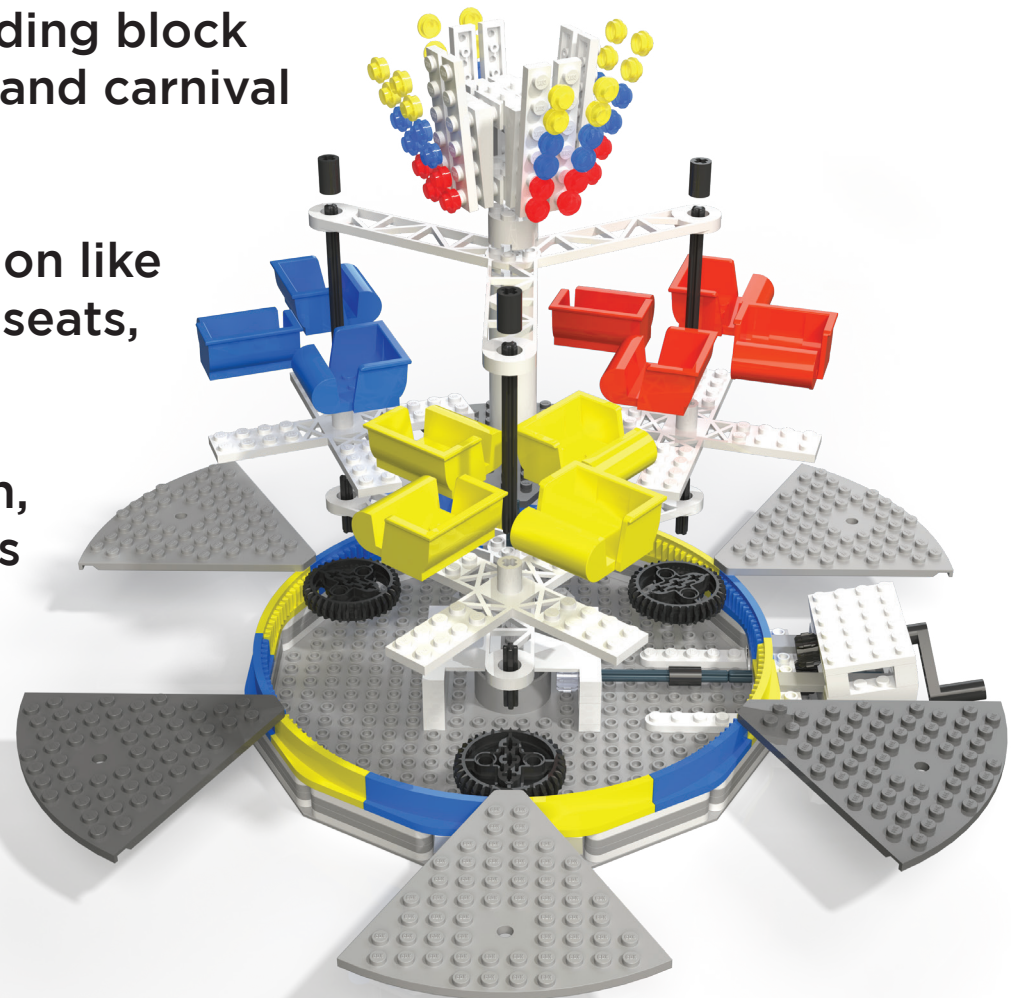



The Tea Cups
 Part Number | CDX-TEA-01
 Wholesale | \$15.00
 Retail | \$29.99
 Box Size | 13.5" x 9" x 2.25"



The Ferris Wheel
 Part Number | CDX-FWH-01
 Wholesale | \$15.00
 Retail | \$29.99
 Box Size | 13.5" x 9" x 2.25"



The Scrambler
 Part Number | CDX-SCR-01
 Wholesale | \$15.00
 Retail | \$29.99
 Box Size | 13.5" x 9" x 2.25"



Accessories

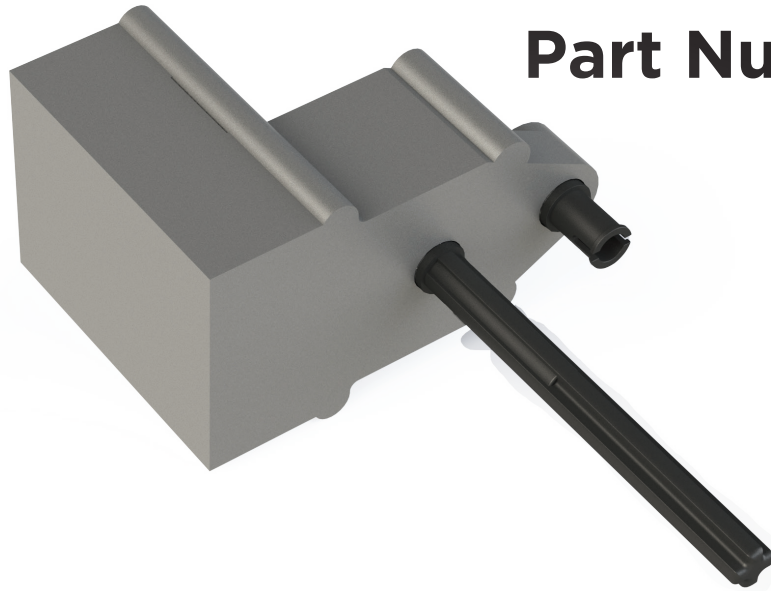

Motor Pack
Part Number | CDX-FMP-01
Wholesale | \$10
Retail | \$19.99



**Motor Pack can be used with any Fun Fair or
Coaster Kit**

**Includes a battery box that requires 2-AA
batteries.**

The Little Dipper
Part Number | CDX-LD-01
Wholesale | \$22.50
Retail | 44.99
Box Size | 15" x 9" x 2.5"
Case Quantity | 8

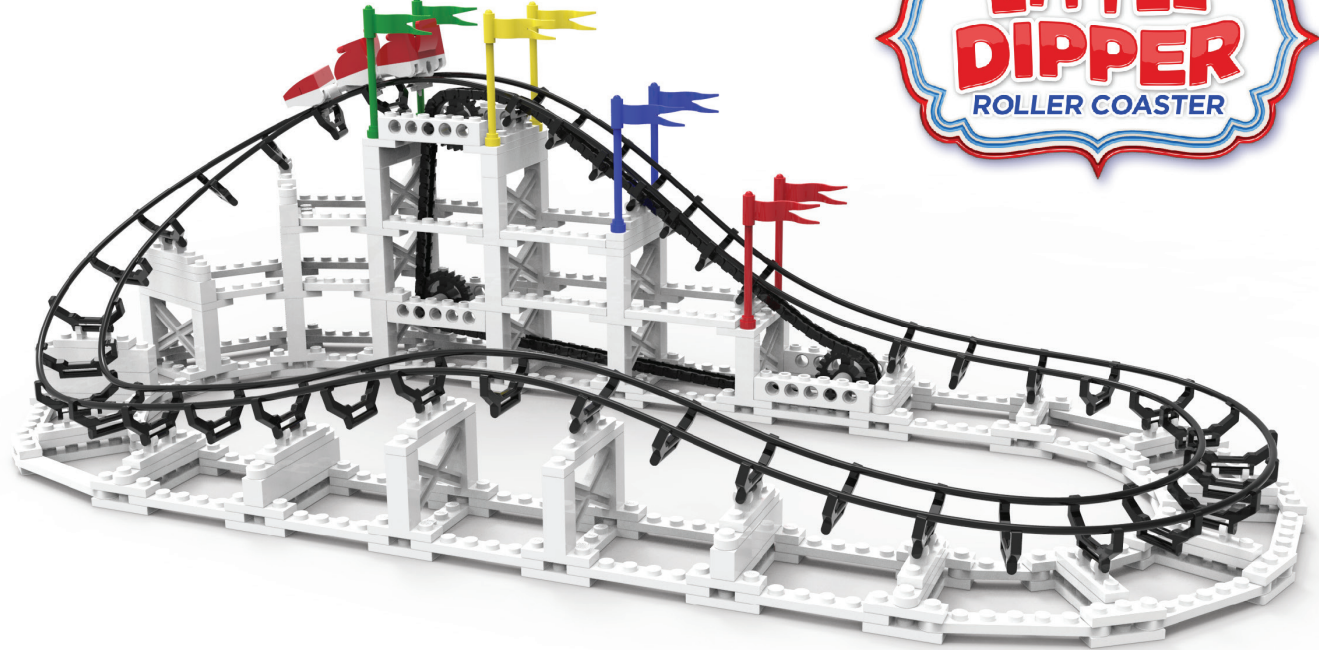

FLYER
ROLLER COASTER

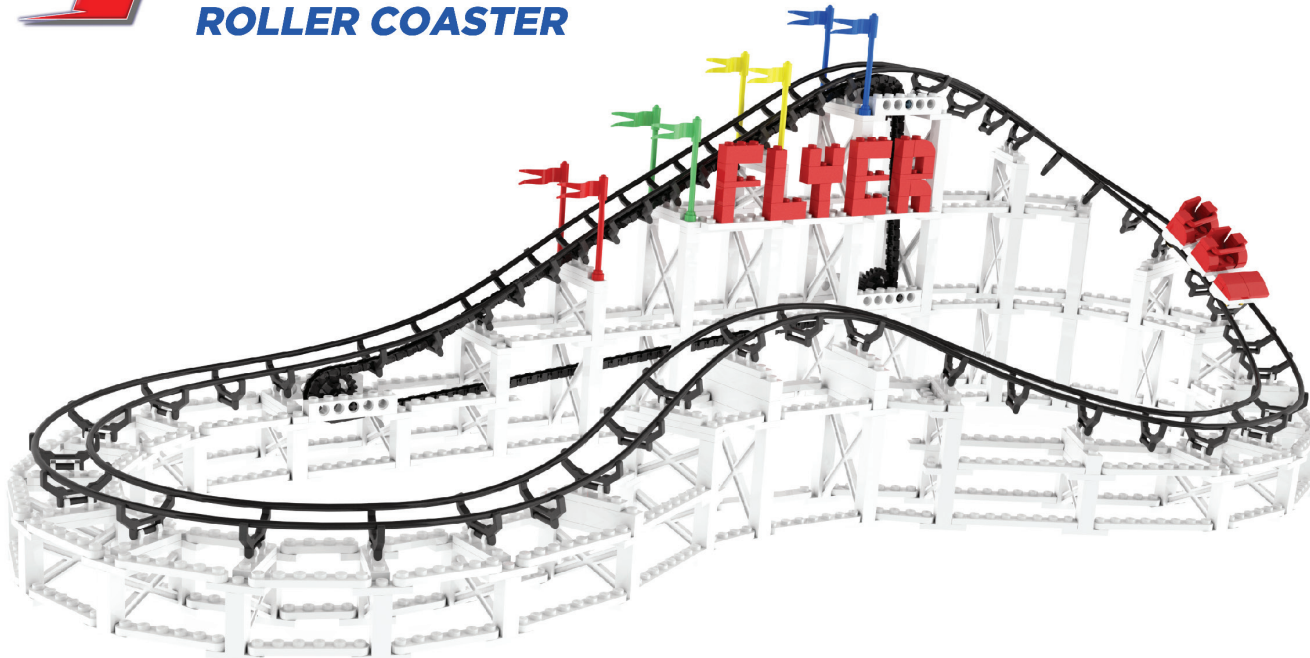

The Flyer
Part Number | CDX-FLY-01
Wholesale | \$40.00
Retail | \$79.99
Box Size | 28" x 12" x 10"
Case Quantity | 8



The Sidewinder
Part Number | CDX-SWR-01
Wholesale | \$60.00
Retail | \$119.99
Box Size | 38" x 15" x 20"
Case Quantity | 5



CYCLONE

ROLLER COASTER



The Cyclone
Part Number | CDX-CYC-01
Wholesale | \$75.00
Retail | \$149.99
Box Size | 48" x 12" x 12"
Case Quantity | 5





Create

CDX Blocks was established by a creative and enthusiastic team of designers, including a real roller coaster engineer! Our models are designed to build quickly and easily. To facilitate assembly, all parts are individually bagged by style and color. CDX Blocks seamlessly integrate with the world's leading building block system. By utilizing larger custom molded parts and fewer smaller parts, we minimize weak connecting points and increase structural rigidity in our models.

Play

At CDX, the emphasis is on PLAY. While other block companies may feel that the challenge of the build is paramount, we believe the ability to interact with the final product is what makes a toy FUN. Building a model is only the start of the interactive journey. CDX roller coaster models are dynamic and exciting. The allure of a roller coaster is hard to deny and transcends generations. Our models allow the consumer to explore everything from building the basic model to combining multiple kits in an effort to recreate their favorite roller coaster design.

Imagine

The beauty of CDX Blocks is that our models are part of a roller coaster "system". Models can be reconfigured and kits may be combined to create an endless array of custom designs. Aspiring roller coaster designers are encouraged to use their imaginations to build larger and more elaborate layouts, all within the constraints of roller coaster physics. Budding engineers learn about the properties of gravity, acceleration, momentum, potential and kinetic energy to create a relevant and fun STEM teaching tool.

www.cdxblocks.com | info@cdxblocks.com | 540-435-7964